

# DPCB PUNCHED PLAIN COPPER BUSBAR, DOUBLE



## CERTIFICATIONS



## FEATURES

- Heavy-duty power connection
- Circuit breaker, generator and prefabricated power network conductor
- Alternative to large and multiple cables
- Earth/ground connection
- Power distribution
- Rounded edges

## SPECIFICATIONS

**Material:** Copper

Table 1/2

Catalog Number	Article Number	Width (W)	Thickness (T)	Length (L)	Hole Size (HS)	A
DPCB100X5	550440	100 mm	5 mm	1750 mm	10.5 mm	75 mm
DPCB125X5	550450	125 mm	5 mm	1750 mm	10.5 mm	100 mm
DPCB50X5	550410	50 mm	5 mm	1750 mm	10.5 mm	25 mm
DPCB63X5	550420	63 mm	5 mm	1750 mm	10.5 mm	38 mm

Catalog Number	Article Number	Width (W)	Thickness(T)	Length (L)	Hole Size (HS)	A
DPCB80X5	550430	80 mm	5 mm	1750 mm	10.5 mm	55 mm
DPCB100X10	550380	100 mm	10 mm	1750 mm	10.5 mm	75 mm
DPCB120X10	550390	120 mm	10 mm	1750 mm	10.5 mm	95 mm
DPCB50X10	550350	50 mm	10 mm	1750 mm	10.5 mm	25 mm
DPCB60X10	550360	60 mm	10 mm	1750 mm	10.5 mm	35 mm
DPCB80X10	550370	80 mm	10 mm	1750 mm	10.5 mm	55 mm

Table 2/2

Catalog Number	Article Number	B	C	Unit Weight
DPCB100X5	550440	25 mm	12.5 mm	7.25 kg
DPCB125X5	550450	25 mm	12.5 mm	9.2 kg
DPCB50X5	550410	25 mm	12.5 mm	3.4 kg
DPCB63X5	550420	25 mm	12.5 mm	4.4 kg
DPCB80X5	550430	25 mm	12.5 mm	5.7 kg
DPCB100X10	550380	25 mm	12.5 mm	14.5 kg
DPCB120X10	550390	25 mm	12.5 mm	18.4 kg
DPCB50X10	550350	25 mm	12.5 mm	6.8 kg
DPCB60X10	550360	25 mm	12.5 mm	8.8 kg
DPCB80X10	550370	25 mm	12.5 mm	11.4 kg

## DIAGRAMS

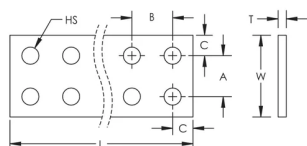

## WARNING

nVent products shall be installed and used only as indicated in nVent's product instruction sheets and training materials. Instruction sheets are available at [www.nvent.com](http://www.nvent.com) and from your nVent customer service representative. Improper installation, misuse, misapplication or other failure to completely follow nVent's instructions and warnings may cause product malfunction, property damage, serious bodily injury and death and/or void your warranty.

#### North America

+1.800.753.9221

Option 1 – Customer Care

Option 2 – Technical Support

#### Europe

Netherlands:

+31 800-0200135

France:

+33 800 901 793

#### Europe

Germany:

800 1890272

Other Countries:

+31 13 5835404

#### APAC

Shanghai:

+ 86 21 2412 1618/19

Sydney:

+61 2 9751 8500



Our powerful portfolio of brands:  
**nVent.com CADDY ERICO HOFFMAN RAYCHEM SCHROFF**  
**TRACER**